



INTERNATIONAL COMPETITION NETWORK
ANNUAL CONFERENCE | 6-8 May 2026 | Manila, Philippines

INFORMATION NOTE FOR PARTICIPANTS

Updated 30 April 2026



The Philippine Competition Commission (PCC) shall host the 25th International Conference Network Annual Conference (ICN Annual Conference) on 06-08 May 2026 at Manila Marriott Hotel, Pasay City, Philippines.

ABOUT THE EVENT

A. ICN Registration

Date: 05 May 2026

Time: 14:00-17:30

Venue: 2nd Floor, Marriott Grand Ballroom

All delegates may begin to claim their conference badges and materials with the ICN AC MNL 2026 Organizing Committee on 05 May 2026. Participants may also register all throughout the conference dates.

The Introduction to ICN booth will also be available to participants on this day.

B. Welcome Reception

Date: 05 May 2026

Time: 19:00-22:00

Venue: Foro de Intramuros

To promote camaraderie among all delegates, the PCC will host a Welcome Reception on 05 May 2026. Complimentary shuttle service will be available at Marriott Hotel Manila starting at 18:00 to transport delegates from the conference venue directly to the Foro de Intramuros and back.

C. ICN Annual Conference

Date: 06-08 May 2026

Time: 08:00-17:45 (06 May), 08:30-17:45 (07 May), 08:30-13:45 (08 May)

Venue: 1st and 2nd Floors, Marriott Grand Ballroom

The ICN is the leading global conference platform that leads comprehensive discussions on the latest developments in competition enforcement and policy. Its annual conference brings together about 400 regulators and experts from over 140 jurisdictions worldwide, enabling them to share knowledge, address prevailing issues and challenges, and develop innovative tools and strategies surrounding competition policy.

D. ICN Conference Dinner

Date: 07 May 2026

Time: 19:00-22:00

Venue: 2nd Floor, Marriott Grand Ballroom

The PCC invites all delegates to the ICN conference dinner showcasing the warmth and hospitality of the Philippines. Attendees are encouraged to wear comfortable clothes in order to participate in the night's festivities.

E. Cultural Tour

Date: 08 May 2026

Time: 13:45-17:45

Venue: Intramuros/National Museum of the Philippines Complex

Due to the anticipated hot weather in the Philippines, delegates are advised to wear comfortable clothes and shoes, and bring umbrellas and fans for the tour. Delegates will be provided shirts and refreshments.

Livestream

Livestream of the plenary sessions will be available on the website landing page. These sessions will be linked at <https://www.icn2026mnl.ph/> and will be available at the PCC Official YouTube page after the conference.

Breakout sessions will not be livestreamed or recorded.

CONFERENCE REGISTRATION

Participants are required to register online via <https://icn2026mnl.ph>. Please keep a copy of the event ticket that was sent to your email address when you registered. The event ticket will be scanned in order to print your conference badge.

To avoid morning queues, delegates are encouraged to collect their badges and materials on 05 May 2026, from 14:00 to 17:30, at the 2nd Floor of the Marriott Grand Ballroom (Foyer D).

On 06 May, registration will open at 8:00 AM, with the first session commencing at 9:00 AM. Please note that for the remainder of the conference, sessions will begin promptly at 8:30 AM.

For security reasons, badges must be worn at all times within the venue. If lost, please report the incident immediately to the Information Counter for a replacement.

CONFERENCE WEBSITE AND MOBILE APP

Visit the ICN Conference website <https://www.icn2026mnl.ph/> or download and install the conference mobile app to stay updated on news and announcements.

ICN Conference App

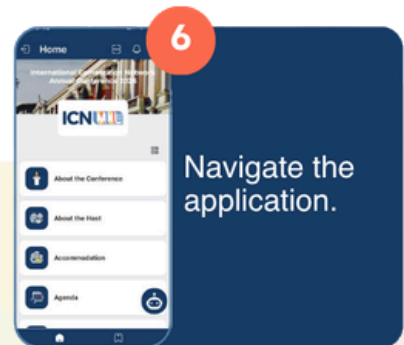
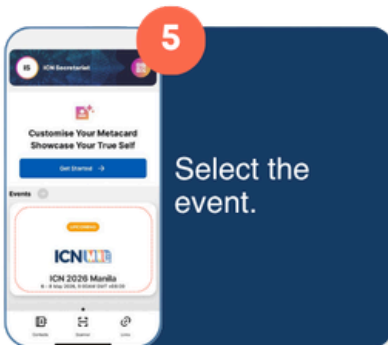
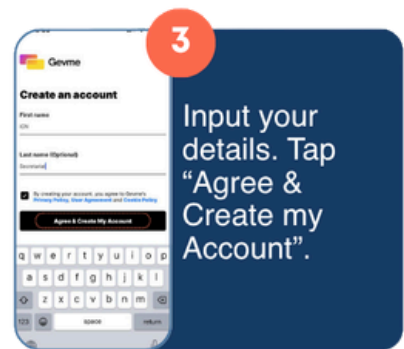
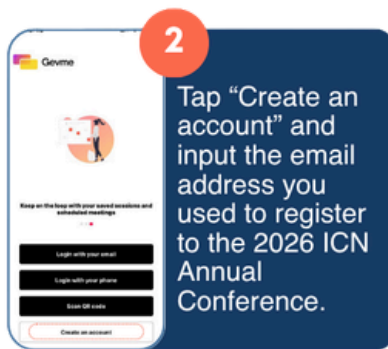
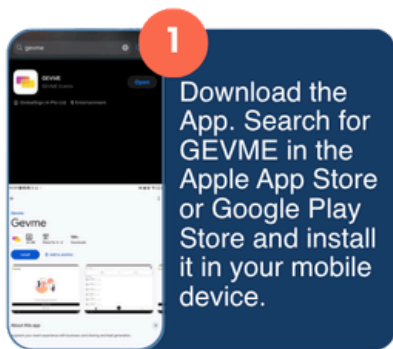

Question & Answer

Participants may easily ask questions through Slido to engage with sessions real-time. Follow the steps below to access the Q&A platform and participate in the discussion.

Access via Gevme App

Open the Gevme App
Click the Q&A button to join Slido
Enter the event code displayed
on LED Screens

Access via Web Browser

Go to: <https://app.sli.do/>
Enter the event code displayed
on LED Screens

Important Notes

- All questions are moderated in real time
- Moderators and panelists will curate questions for relevance and flow

Media Guidelines

Sessions/Activities

- Media may attend plenary sessions, which will also be livestreamed.
- Breakout sessions, and social and other non-plenary activities are not open to media. Media may access designated areas during program breaks and meals; however, filming and recording are strictly prohibited in these areas.

Interviews

- Interviews may only be conducted in the designated room.
- Requests must be coordinated in advance and are subject to the consent and availability of participants.

For inquiries regarding media participation, please contact the Organizing Committee at reg.icnmnl@phcc.gov.ph.

VENUE

The ICN Annual Conference will be held at the Marriott Grand Ballroom of the Manila Marriott Hotel, Pasay City.

Information on the venue can be found here: [Manila Marriott Hotel](#)



Ground Floor

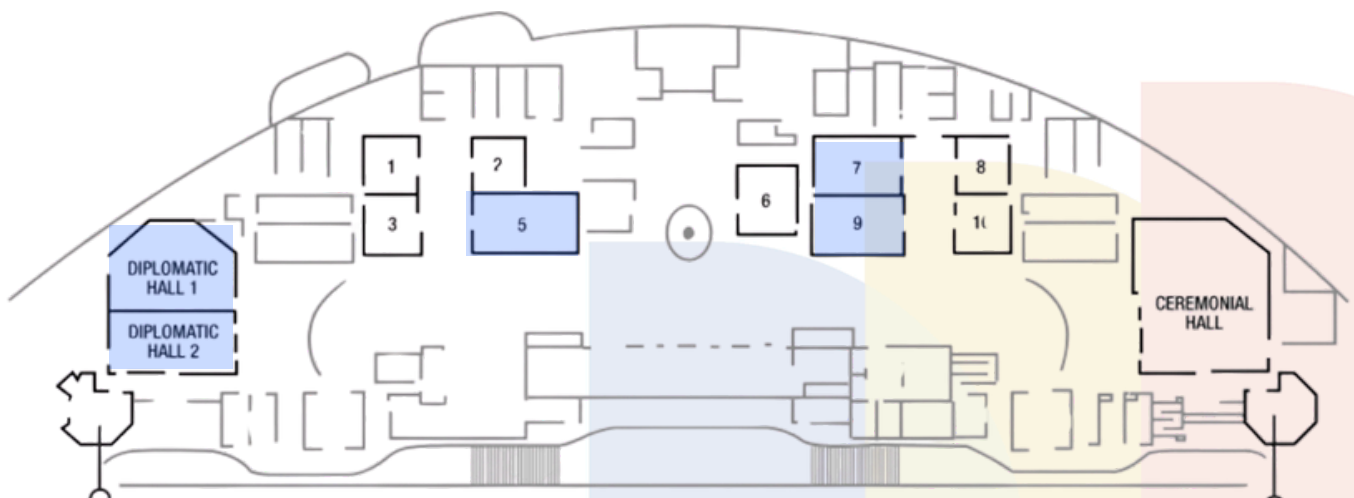

- Side Events and Breakout Rooms (Diplomatic Hall, MGB Exec Room 5 and Exec Room 7&9)

Second Floor

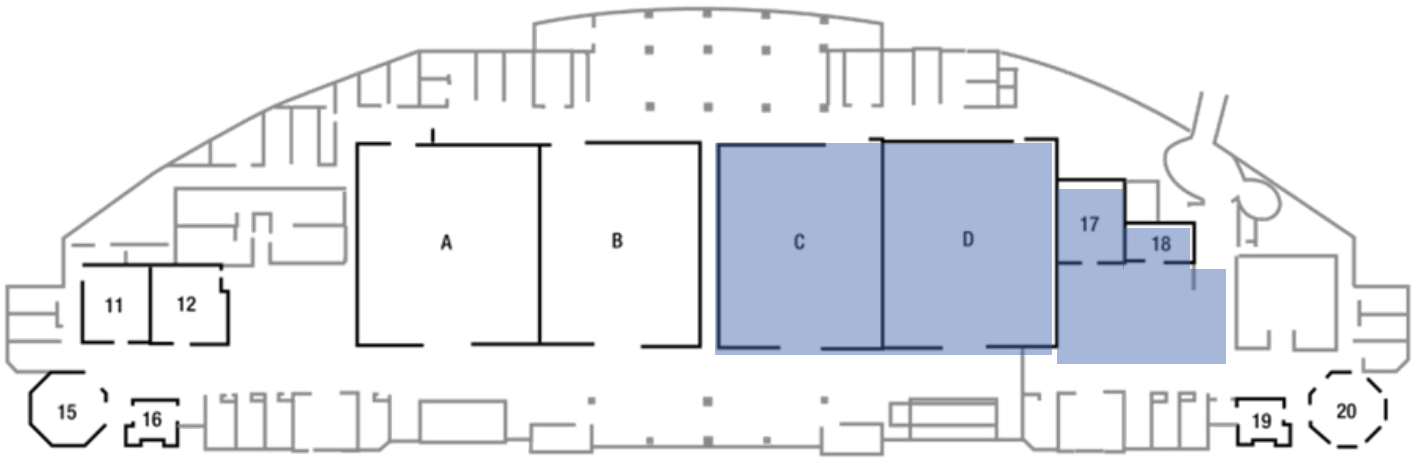

- Foyer
- Registration Area
- Coffee Break Area
- Plenary Sessions (MGB Ballroom C&D)
- Organizing Committee Room/Supplier's Holding Room (MGB Exec Room 17)
- Media Room (MGB ER18)

Third Floor

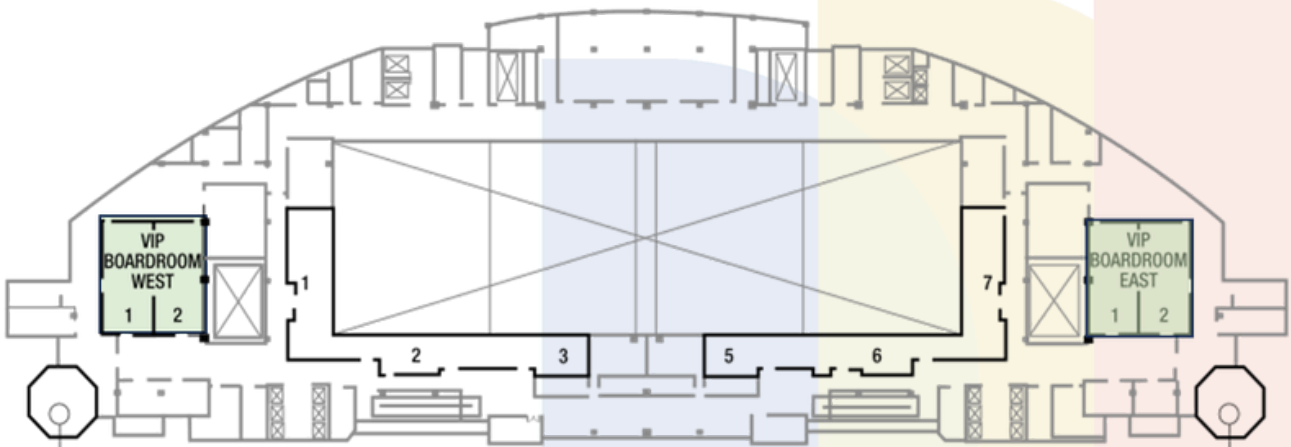

- Breakout Room (VIP West Boardroom)
- Breakout Room (VIP East Boardroom)

Delegation Hall, Lower Ground Floor

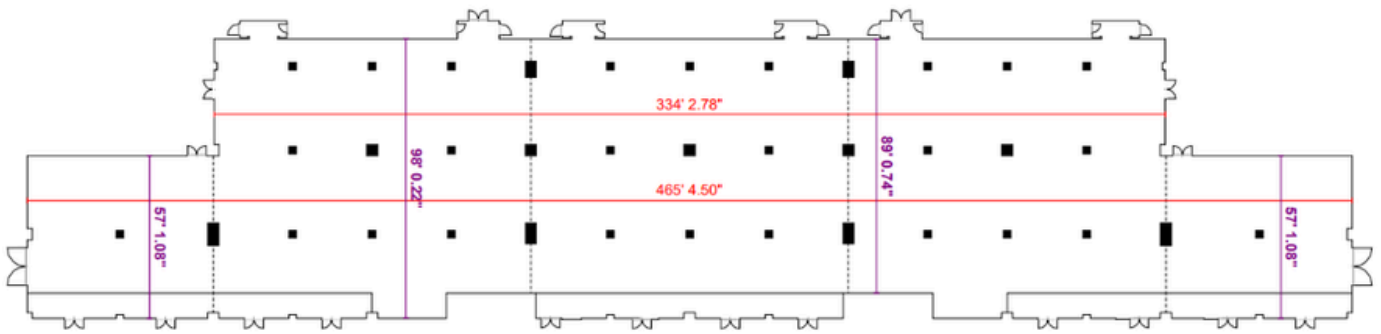

- Lunch
- Booths
- Collab Working Space
- Activity Area
- Supplier's Holding Room
- Meeting Rooms

TRAVELLING TO THE PHILIPPINES

Protocols

All arriving and departing passengers must register via the eTravel Portal at <https://etravel.gov.ph>. Participants may also download the app via their mobile application stores.

Participants may register within 72 hours prior to arrival or departure in the Philippines. Registration to site is free of charge.

Airport Arrival/Departure (*Terminal updates effective 29 March 2026*)

Ninoy Aquino International Airport (NAIA) is the recommended port of entry and departure for the conference period.

Terminal 1	International Philippine Airlines (PR) Air China (CA), Air India (AI), Air Niugini (PX), Asiana Airlines (OZ), China Airlines (CI), China Eastern (MU), EVA Air (BR), Hong Kong Airlines (HX), Japan Airlines (JL), Korean Air (KE), Kuwait Airways (KU), Malaysia Airlines (MH), Oman Air (WY), Royal Air (RW), Royal Brunei Airlines (BI), Saudia Airlines (SV), Vietnam Airlines (VN), Xiamen Air (MF), ZIPAIR Tokyo (ZG)
Terminal 3	Domestic and International Cebu Pacific (5J), AirAsia (Z2 / AK), All Nippon Airways (NH), Cathay Pacific (CX), China Southern Airlines (CZ), Emirates (EK), Ethiopian Airlines (ET), Etihad Airways (EY), Gulf Air (GF), Hong Kong Express (UO), Jeju Air (7C), Jetstar Asia (3K), Jetstar Japan (GK), KLM Royal Dutch, Airlines (KL), Qantas (QF), Qatar Airways (QR), Scoot (TR), Singapore Airlines (SQ), STARLUX Airlines (JX), Thai Airways (TG), Turkish Airlines (TK), United Airlines (UA)

Visa Requirements

Participants are required to obtain an appropriate entry visa from the Embassy of the Republic of the Philippines before entering the Philippines except for those listed as visa-free.

VISA-FREE ENTRY FOR 30 DAYS STAY

Andorra	Brazil*	Congo, Democratic Republic	Eswatini (Swaziland)
Angola	Brunei	Costa Rica	Ethiopia
Antigua and Barbuda	Bulgaria	Cote d'Ivoire	Fiji
Argentina	Burkina Faso	Croatia	Finland
Australia	Burundi	Cyprus	France
Austria	Cambodia	Czech Republic	Gabon
Bahamas	Cameroon	Denmark	Gambia
Bahrain	Canada	Djibouti	Germany
Barbados	Cape Verde	Dominica	Ghana
Belgium	Central African Republic	Dominican Republic	Greece
Belize	Chad	Ecuador	Grenada
Benin	Chile	El Salvador	Guatemala
Bhutan	Colombia	Equatorial Guinea	Guinea
Bolivia	Comoros	Eritrea	Guinea-Bissau
Botswana	Congo	Estonia	Guyana

Haiti	Liechtenstein	Nepal	San Marino
Honduras	Lithuania	Netherlands	Sao Tome and Principe
Hungary	Luxembourg	New Zealand	Saudi Arabia
Iceland	Madagascar	Nicaragua	Senegal
Indonesia	Malawi	Niger	Seychelles
Ireland	Malaysia	Norway	Singapore
Israel*	Maldives	Oman	Slovak Republic
Italy	Mali	Palau	Slovenia
Jamaica	Malta	Panama	Solomon Islands
Japan	Marshall Island	Papua New Guinea	South Africa
Kazakhstan	Mauritania	Paraguay	Spain
Kenya	Mauritius	Peru	St. Kitts and Nevis
Kiribati	Mexico	Poland	St. Vincent and the Grenadines
Korea, Republic of	Micronesia	Portugal	Suriname
Kuwait	Monaco	Qatar	Sweden
Kyrgyzstan	Mongolia	Romania	Switzerland
Laos	Morocco	Russia	Tajikistan
Latvia	Mozambique	Rwanda	Tanzania
Lesotho	Myanmar	Saint Lucia	Thailand
Liberia	Namibia	Samoa	Togo

Tunisia	United Arab Emirates	Vanuatu	Zambia
Turkmenistan	United Kingdom	Vatican	Zimbabwe
Tuvalu	United States of America	Venezuela	
Türkiye	Uruguay	Vietnam	

Brazil and Israel passports- fifty-nine (59) days

Hongkong SAR passports and Macau SAR passports- fourteen (14) days

India passports fourteen (14) days subject to terms and conditions

Hongkong British passports seven (7) days

Mainland Chinese passports- seven (7) days subject to terms and conditions

Participants not included in the visa-free list may proceed to apply for a 9(a) Temporary Visitor’s Visa at the nearest Philippine Embassy or Consulate in their country of origin/legal residence.

Requirements for Issuance of Temporary Visitor’s Visa

1. Duly accomplished visa application form (FA Form No. 2) with a passport-size photograph taken during the last six (6) months
2. Passport valid for at least six (6) months beyond authorized period of stay in the Philippines
3. Tickets or flight reservation (entry and exit)
4. For business purposes, letter from employer or sponsor (which may be the inviting in the Philippines) indicating the specific purpose of travel, length of stay (inclusive dates), and company guarantee for all moral and financial obligations to be incurred by the applicant while in the Philippines
5. Proof of Income
6. Hotel accommodation or proof of lodging

Download the FA Form No. 2 visa application form here: <https://consular.dfa.gov.ph/list-of-consular-forms/>

Visit the link for more helpful information:

<https://evisa.gov.ph>; <https://dfa.gov.ph/about/dfa-directory/our-foreign-service-posts-dfa>

Airport Courtesy/Diplomatic Lanes

Airport courtesy lanes for all ICN delegates and their companions are available to expedite the arrival process. Interested parties should supply the following information to be forwarded to the Bureau of Immigration for advance verification:

- Arrival and Departure Flight Details. Includes name of airline, flight numbers, dates of arrival and departure, assigned airport terminals
- Passport Biopage. Contains the passport number and signature. Please remember to include the passport biopage of companions.

The sign-up form for the airport courtesy lane and airport shuttle service (Travel and Logistics Information form) can be found in the Registration Confirmation emails you have received (*SUBJECT: Confirmation of Registration – 2026 ICN Annual Conference in Manila, Philippines*). Kindly note that sign-in is required due to the file upload component. Should you have problems accessing the form, please inform the Organizing Committee via reg.icnmnl@phcc.gov.ph.

Please look for the Diplomatic, ASEAN, or APEC lanes at the immigration counters in Terminals 1 and 3. Note that only travelers who have registered and provided their flight details in advance are permitted to use these lanes.



Terminal 1



Terminal 3

TRANSPORTATION

Airport Shuttle Service

Airport shuttle service is available to bring all ICN delegates and their companions to select accommodations within Newport World Resorts (Manila Marriott Hotel, Hilton, Sheraton, Belmont, Savoy and Holiday Inn) and vice versa from 5-9 May 2026.

TERMINAL 1

1



After Immigration, proceed to collect your luggage at the designated baggage conveyor belt.

2

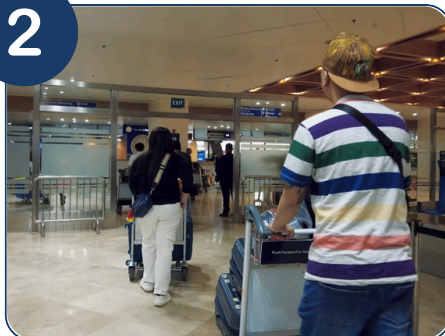

Proceed toward the Arrivals Exit

3

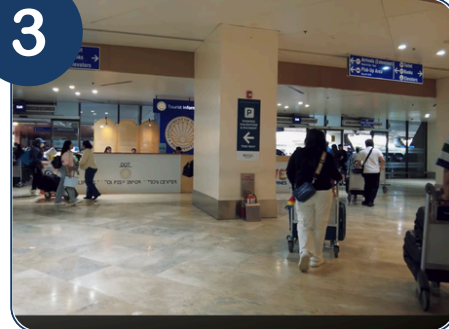

Continue along the designated pathway leading to the Arrivals Exit.

4



Head to the temporary ICN assistance desk located at the Tourist Information Center for shuttle service guidance.

5

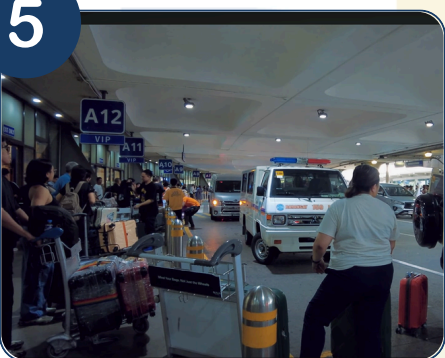

Proceed towards designated areas (bays A11 or A12) for shuttle service the assigned loading bays.

6



Meet the shuttle dispatcher holding an "ICN MNL 2026" sign.

TRANSPORTATION

TERMINAL 3

1



After Immigration, proceed to collect your luggage at the designated baggage conveyor belt.

2



Proceed toward the Arrivals Exit

3



Continue along the designated pathway leading to the Arrivals Exit.

4



Head to the temporary ICN assistance desk located at the Tourist Information Center for shuttle service guidance.

5



Proceed towards designated areas (bays 6 or 7) for shuttle service the assigned loading bays.

6



Meet the shuttle dispatcher holding an "ICN MNL 2026" sign.

Delegates who miss the airport shuttle can also opt to arrange their own transportation through ride-hailing apps such as Grab, InDrive, Green GSM, JoyRide, Lalamove Ride, etc. The onsite coordinators on standby can assist the delegates in booking through apps.

Designated pick-up points for ride hailing apps

Terminal 1

Estimated Travel Time: 15-20 mins

Pick up points:

Main Arrival Curbside

Private vehicles - A1 to A14

PWDs - A8 to A9

VIP pick up - A11 to A12

Additional pick-up area Curbside

B1 to B6

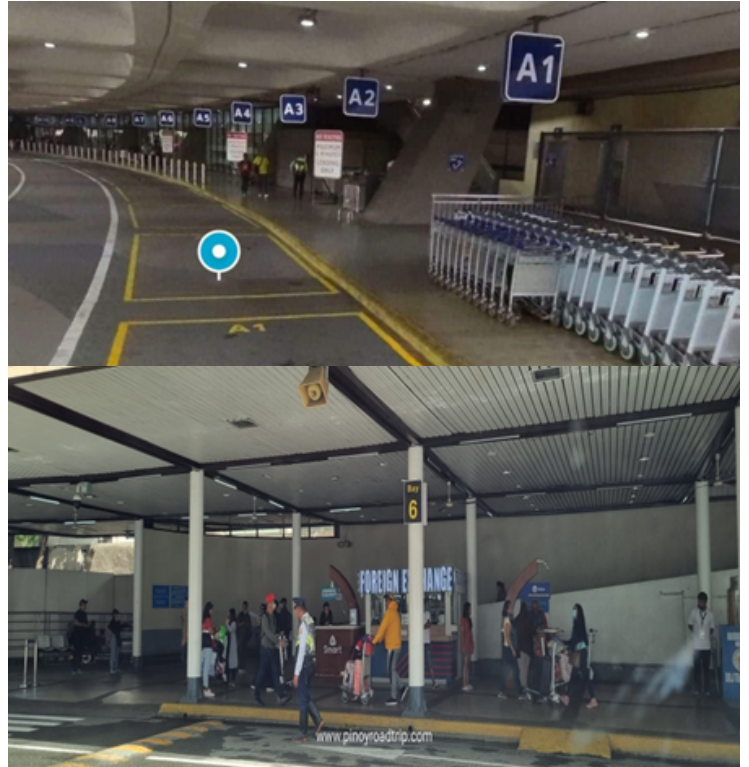

Terminal 3

Estimated Travel Time: 5-10 mins

Pick up instructions:

Utilize the centralized ride-hailing hub located at the multi-level parking building



Another option for delegates arriving at Terminal 3 is to take the Runway Manila going to Manila Marriott Hotel and other accommodations within Newport City.

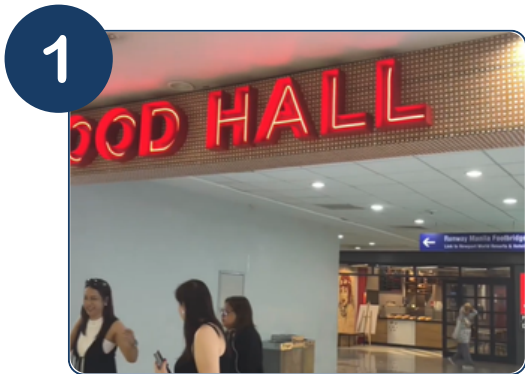

From NAIA Terminal 3, proceed toward the departure hall area and follow the overhead signs leading to Runway Manila

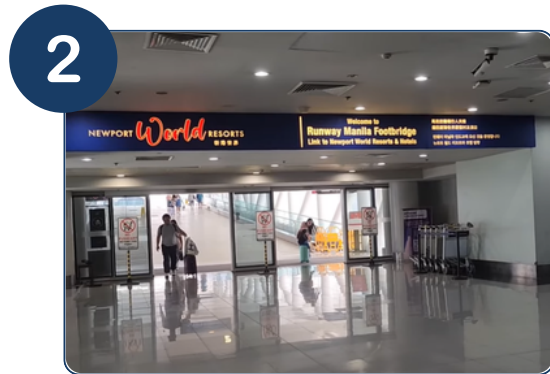

Continue walking and follow the overhead signs directing you to Runway Manila/Newport City



Enter the covered skybridge and walk straight along the waitlist pathway.



Exit at the end of the bridge leading to the Newport City area.

Alternatively, there is an available shuttle that can take you to your accommodation within Newport City free of charge.



Shuttle Service to and from Manila Marriott Hotel

Shuttle services to and from the Marriott are provided for delegates staying at the following hotels:

- Hilton Manila
- Sheraton
- Holiday Inn Express
- Belmont
- Savoy

If your accommodation is not listed above, you are advised to arrange your own transportation. The full schedule and specific pick-up times will be sent in a subsequent email advisory.

In-City Transportation

A shuttle service is also available for city exploration from 6-7 May 2026 following the routes below:

CLUSTER 1: Manila

Mall of Asia - Rizal Park - Manila Ocean Park - Likhang Pilipino Exhibition Hall

CLUSTER 2: Makati and Bonifacio Global City

Ayala Museum - Greenbelt - Bonifacio High Street - Metropolitan Museum

Delegates may also visit the Secretariat at the Information Counter, located in the Registration Area on the 2nd Floor. Any additional information on routes and schedule will also be available via the conference app.

Accommodation

The list of recommended hotels with addresses, classification, proximity to the venue and other related information are listed below.

Participants should make reservations directly with the recommended hotels based on the list. Cancellations, postponements or other changes should be reported immediately to the hotel. Rooms not occupied may be charged to the participants in accordance with hotel policies.

Before departure, participants should settle directly with the respective hotels all accounts, including room charges and other expenses including local and long-distance telephone calls, internet usage, business center usage, laundry, room and hotel transportation services, mini-bar items, as well as restaurant and bar services.

Participants are also accountable for any charges incurred with respect to rooms remaining vacant owing to late arrival or rescheduled departure for which inadequate prior notice is given.

Hotel Name	Website	Phone Number	Approximate Rates (USD/night)	Distance by Car (approx.)	Distance by Walking (approx.)
5-Star Hotels					
Marriott Hotel Manila	https://www.marriott.com/en-us/hotels/mnlap-manila-marriott-hotel-at-newport-world-resorts/overview/	+63 28 988 9999	\$200 - \$350+	0km	0 km
Sheraton Manila Hotel	https://www.marriott.com/en-us/hotels/mnlsi-sheraton-manila-hotel-at-newport-world-resorts/overview/	+63 2 7902 1800	\$150 - \$350+	2.6km	8 minutes

Hotel Name	Website	Phone Number	Approximate Rates (USD/night)	Distance by Car (approx.)	Distance by Walking (approx.)
5-Star Hotels					
Hilton Manila	https://www.hilton.com/en/hotels/mnlpphi-hilton-manila/	+63 2 7239 7788	\$140 - \$300+	650m	3 minutes
Conrad Manila	https://www.hilton.com/en/hotels/mnlmbci-conrad-manila/	+63 2 8833 9999	\$160 - \$400+	8 km	60-70 minutes
Okada Manila	https://okadamanila.com	+63 2 8888 0777	\$200 - \$500+	6-8 km	100-120 minutes
Hyatt Regency Manila, City of Dreams	https://www.hyatt.com/hyatt-regency/en-US/mnlhy-hyatt-regency-manila-city-of-dreams	+1 469 610 3608	\$130 - \$300+	5-7 km	50-65 minutes
Solaire Resort Entertainment City	https://www.solaireresort.com	N/A	\$180 - \$450+	7-9 km	60-70 minutes
4-Star Hotels					
Belmont Hotel Manila	https://www.belmonthotelmanila.com	+63 2 5318 8888	\$90 - \$180	350 m	1-2 minutes
Savoy Hotel Manila	https://www.savoyhotelmanila.com.ph/en	N/A	\$85 - \$170	2.4km	9-10 minutes
3-Star Hotel					
Holiday Inn Express Manila Newport City	https://www.ihg.com/holidayinnexpress/hotels/us/en/pasay/mnlrm/hotel-detail	+63 2 7908 8600	\$80 - \$150	550 m	6 minutes

OTHER INFORMATION

Time Zone

The Philippine Standard Time is 8 hours ahead of GMT (GMT +8).

Weather

The average temperature during May typically ranges from 26°C (79°F) at night to 34°C (93°F) during the day. It's generally one of the hottest months of the year, with high humidity (often over 70%) and occasional afternoon thunderstorms as the country approaches the start of the rainy season in June.

Currency

The official currency of the Philippines is the Philippine Peso (PhP). Retailers in the Philippines do not accept other currencies. Delegates may wish to change their currencies at the airport after clearing immigration or customs or at exchange counters near the hotel for better rates. Major international credit cards are widely accepted.

ATMs near the venue:

Marriott Hotel Manila
Ground Floor Lobby, Marriott Hotel Manila

BPI
Ground Floor Resorts World Manila

BDO
Ground Floor, Newport Mall

Internet Connection

Guests can enjoy free public Wi-Fi in many parts of the Philippines. Major airports also provide high-speed, unlimited Wi-Fi. Complimentary internet is also available in many malls, cafés, hotels, and transport terminals. Wi-Fi at the conference venue will also be available.

For more reliable connectivity, guests can purchase a local prepaid SIM or eSIM from major telecom providers. Physical SIMs are available at airport kiosks, official telco shops, and convenience stores, while eSIMs can be bought online before arrival via global platforms.

Power Plugs and Sockets

Power plugs and sockets in the Philippines use Type A and Type B connectors. The standard voltage is 220V with a frequency of 60Hz. Travelers are advised to bring a universal power adapter to ensure compatibility with local outlets.



Smoking Areas

Metro Manila implements designated smoking places policy. This imposes stiff penalties and other sanctions in violation of this ordinance. However, designated areas in public places and selected establishments are also provided. Please check with your booked accommodation for designated smoking places.

CONTACT INFORMATION

PCC's ICN Annual Conference Organizing Committee: icn2026mnl@phcc.gov.ph

WhatsApp/Viber: +63 917 848 9315

